

TO ORDER PLEASE QUOTE PART NUMBER A-5004-7591

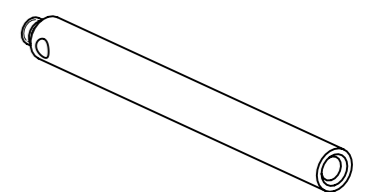

SCALE 2:1

<p>THIS IS A CUSTOMER DRAWING. DIMENSIONS ARE GENERALLY NOMINAL EXCEPT WHERE TOLERANCED.</p> <p>TOLERANCED DIMENSIONS ARE CONSIDERED CRITICAL AND ARE INSPECTED BY OUR QUALITY DEPARTMENT PRIOR TO DESPATCH.</p> <p>ALL DIMENSIONS ARE IN MILLIMETRES. DRAWING PRACTICE TO BS 8888.</p>	<p>3rd ANGLE PROJECTION</p> <p>DO NOT SCALE</p>	<p>TITLE</p> <p>M2 EXT L30 D3SS</p>		<p>ISSUE No.</p> <p>-</p>	<p>DRAWN BY</p> <p>PE</p>	<p>DRAWN DATE</p> <p>DEC 16</p>
		<p>MATERIAL TYPE CODE</p>	<p>MATERIAL</p> <p>STAINLESS STEEL</p>		<p>SHEET</p> <p>1 OF 1</p>	<p>CHECKED</p> <p>-</p>
<p>CONFIDENTIAL. THIS DRAWING IS THE PROPERTY OF © RENISHAW plc, AND MAY NOT BE COPIED OR USED FOR ANY PURPOSE, OTHER THAN THAT FOR WHICH IT IS SUPPLIED, WITHOUT THE EXPRESS WRITTEN AUTHORITY OF RENISHAW plc.</p>		<p>RENISHAW®</p> <p>Wotton - under - Edge Glos. England. GL12 8JR</p>		<p>SCALE</p> <p>U.O.S.</p> <p>5:1</p>	<p>DRAWING No.</p> <p>N-5004-7591-00-A</p>	