

PLANONLIGHT LED 30 W/S M12

Light field luminaire.



hagnleone
LIGHTING

EN

DATA SHEET

Please read installation instructions carefully before commissioning!

PLANONLIGHT LED 30 W/S M12
Item no. 20051

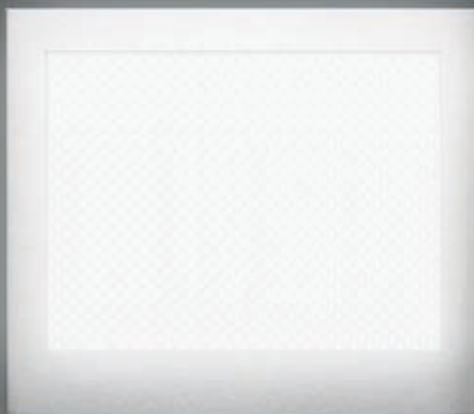

Hagnleone GmbH

Bobletten 36
6850 Dornbirn, Austria
T +43 (0) 5572 394440
F +43 (0) 5572 394841
leuchten@hagnleone.at

www.hagnleone.at

TECHNICAL DATA: (These are typical values which can deviate in series production)

Type designation:	L x W x H:	Operating voltage:	Power:	Illuminated area:	Temperature range:	Weight:	Light colour:
PLANONLIGHT LED 30 W/S M12	358 x 298 x 23.5 mm*	24 VDC**	30 W	219 x 296 mm	-20 °C bis +55 °C	5500 g	6500 K

* Installation height including plug 60.0 mm. ** Voltage range 22 VDC to max. 26 VDC; below 22 VDC brightness losses possible.

FIXING CENTRES:

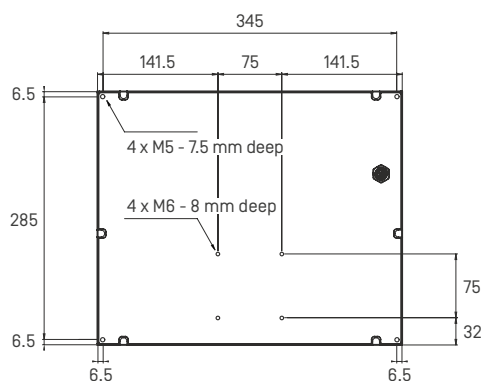

PLANONLIGHT LED 30 W/S M12 DIMENSIONS:

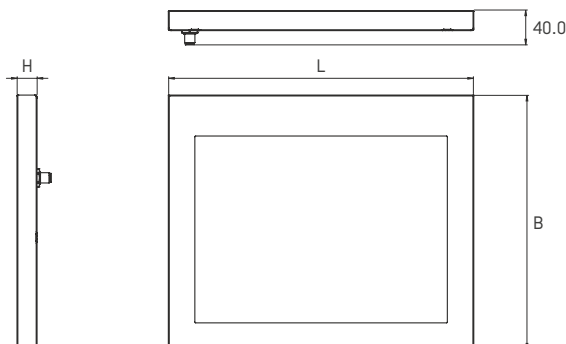

LAMP HOLDER DIMENSIONS:

Item no. 10404

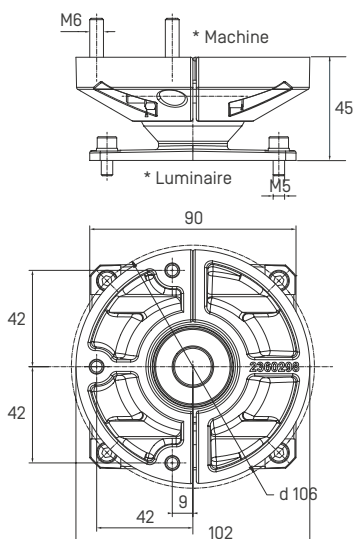

CABLE CONNECTION:

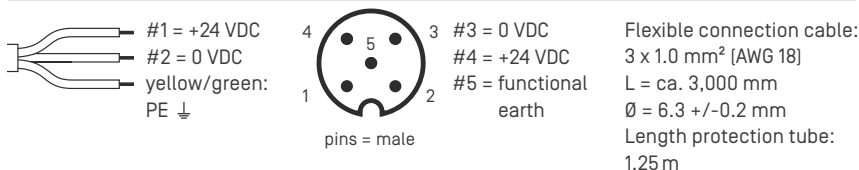

IMPORTANT NOTES:

Installation with lamp holders or directly via the four fixing centres.
Keep lamp wire as short as possible.
Direct connection to the mains voltage damages the lamp!
The plug must not be opened (marking with sealing wax).
If the sealing wax is broken, the warranty expires.
The lamp is suitable for direct mounting on normal flammable surfaces.
RoHs compliant, observe WEEE directive for waste electrical and electronic equipment.
All types have the protection class III (SELV), IP protection class IP68 + IP69k, CE and CB.
Standards: IEC 60598-1, IEC 60598-2-1, UL 2108, UL 8750
Differences in brightness of +/-5% depending on the technology are normal.
Failure of individual LEDs does not constitute grounds for a complaint as long as the difference in brightness is less than 5%.
Tested in lathes and milling machines with standard lubricants.
A detailed installation guide can be found under: www.hagnleone.at

